

STC Valve strives to continuously improve products to ensure customers receive the best quality. Our stainless steel gripper-style (W) fitting is an updated version of our collet-style fittings, with improvements made to the tubing connection & release button.

New Gripper-Style (W) Fitting

Old Collet-Style Fitting

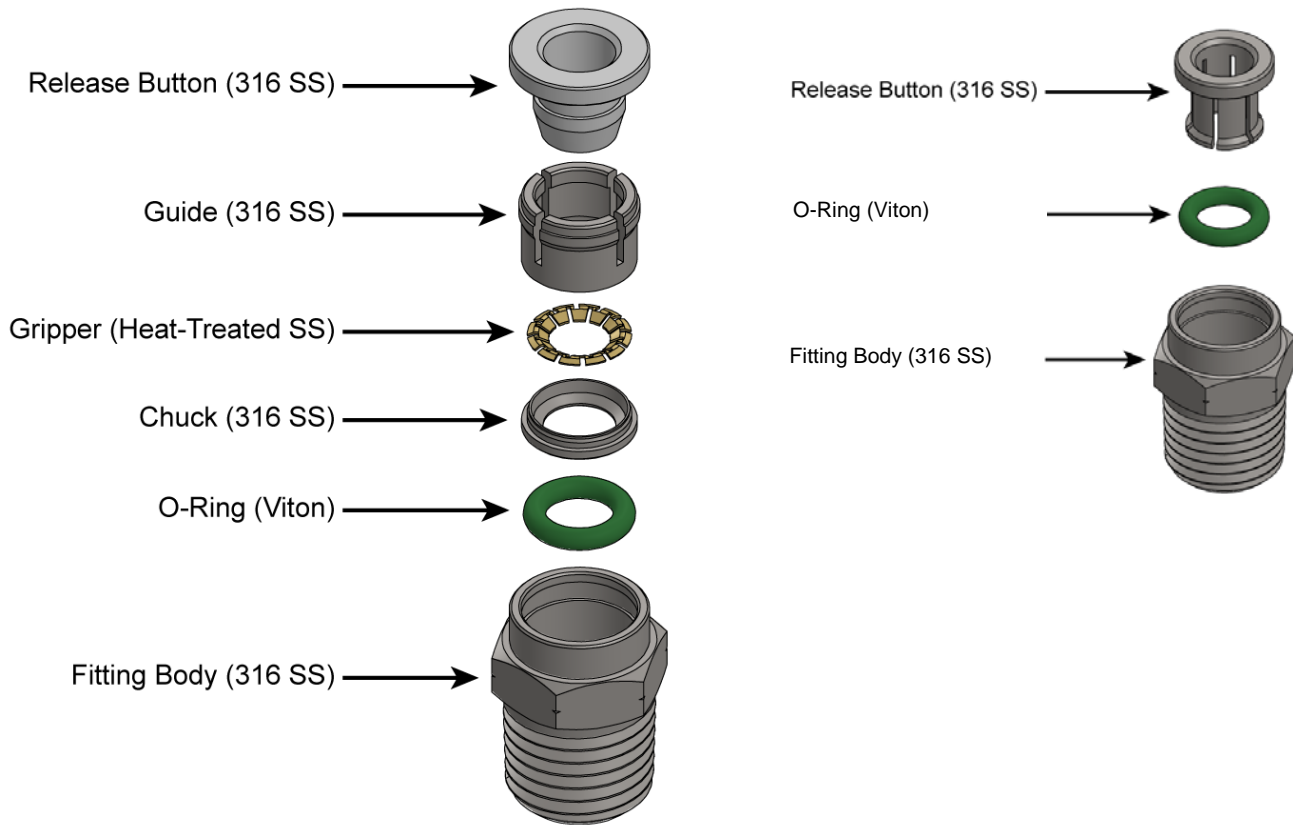

STC Gripper-Style Fitting Advantage	Previous Collet Design
<p>1 When the release button is depressed, the gripper ring retracts, allowing for easy tubing installation. When the release button is released, the gripper ring clinches the tubing creating a good seal and preventing the tubing from getting pulled out.</p>	<p>The release button is the only mechanism to hold the tubing in place, relying on the compression of the release button itself to hold the tube in place. While this connection is reliable, the addition of the gripper allows for stronger connections in more harsh environments.</p>
<p>2 Removal of tubing is easier with the gripper-style fitting. When the release button is depressed, the gripper ring is no longer in contact with the tubing and tubing can easily be removed.</p>	<p>The release button on the collet design cannot be depressed, making it difficult to remove the tubing.</p>
<p>3 In harsh conditions, pre-grooved metal tubing can take full advantage of the gripper mechanism to create a reliable, sturdy connection. In addition, the metal tubing can be easily removed with the redesigned release button.</p>	<p>Pre-grooved metal tubing can be used, but can be difficult to remove from the fitting.</p>